

KENTUCKY HISTORIC RESOURCES
Individual Inventory Form

Resource # OL-583
Oldham County

1. Name of Resource: William Logsdon House

2. Original Owner: William Logsdon

3. Other Names: -

4. Prehistoric Site Building Object
Historic Site Structure Other

5. Location: 110 Ash Avenue (Southwest side of Ash between La Grange Road and Elm)

6. Owner's Name: Norman and Karen Sue Clark, Jr. [P]

7. Owner's Address: 110 Ash Avenue
Pewee Valley, Ky. 40256

8. Evaluation: [I]

9. Recognition & Date:
 Nat. Landmark _____ Local Landmark _____
 Nat. Register Aug., 1989 HABS/HAER _____
 Highway Marker _____ KY Inventory _____
 KY Landmark Certificate _____

10. N.R. Status & Date: NV, August, 1989

11. N.R. Group:
 District Name: Ashwood Avenue Historic []
 Mult. Resource Area: Distinct []
 Thematic Name: []

12. Historical Theme:
 Primary: N.A. []
 Secondary: []
 Other: []

13. Statement of Significance:
N.A.
Determined non-contributing due to major alterations.

14. History:
Built by William Logsdon and family in 1936 to replace a much larger house destroyed by fire.
Present owners have drastically altered house.

15. Source of historical information and/or contact person:

16. Date:
 Original Building 1936 [3]
 Addition 1980s [1]

17. Style: English Cottage [5E]

18. Architect/Builder: Unknown

19. No. of Stories: One-and-one-half [1.5]

20. Original Floor Plan: Unknown []

21. Single Pile Double Pile N.A.

22. Roof Form & Material: Gable Original
 Not Original

23. Structural Material: Wood-sawn [W]

24. Exterior Material: Wood-weatherboard [W]

25. Foundation Material: Poured concrete [R]

26. Major Alterations: Added None
 Moved/Rebuilt Other

27. Special Features: Picturesque front chimney

28. Outbuildings: Garage-1930s [N.C.]

29. Original Function: Single dwelling [OIA]

30. Present Use: Single dwelling [OIA]

31. Condition: Good [G]

32. Endangered: Yes
 No

33. Attach Photos:
 Roll: 3 Photo Nos: 8 No. of Slides: _____

34. Prepared by: Cowlyn S. Smith

35. Organization: Consultant

36. Date: September 20, 1989

37. New Survey Resurvey

KENTUCKY HISTORIC RESOURCES
Individual Inventory Form

Resource

38. UTM Point of Primary Building: Zone Easting Northing
 Quadrant: Crestwood 16 632080 4240710
39. G.I.S. Mod. 40. Coordi. Accuracy
41. UTM Points of Boundary (for N. R. eligible sites only):
 A. ----- D. -----
 B. ----- E. -----
 C. ----- F. -----
42. Total Acreage in Present Property: Approx. 2 43. Acreage included in proposed N.R. boundary: Approx. 2
44. Site Plan (and boundary description and justification for N.R. sites):

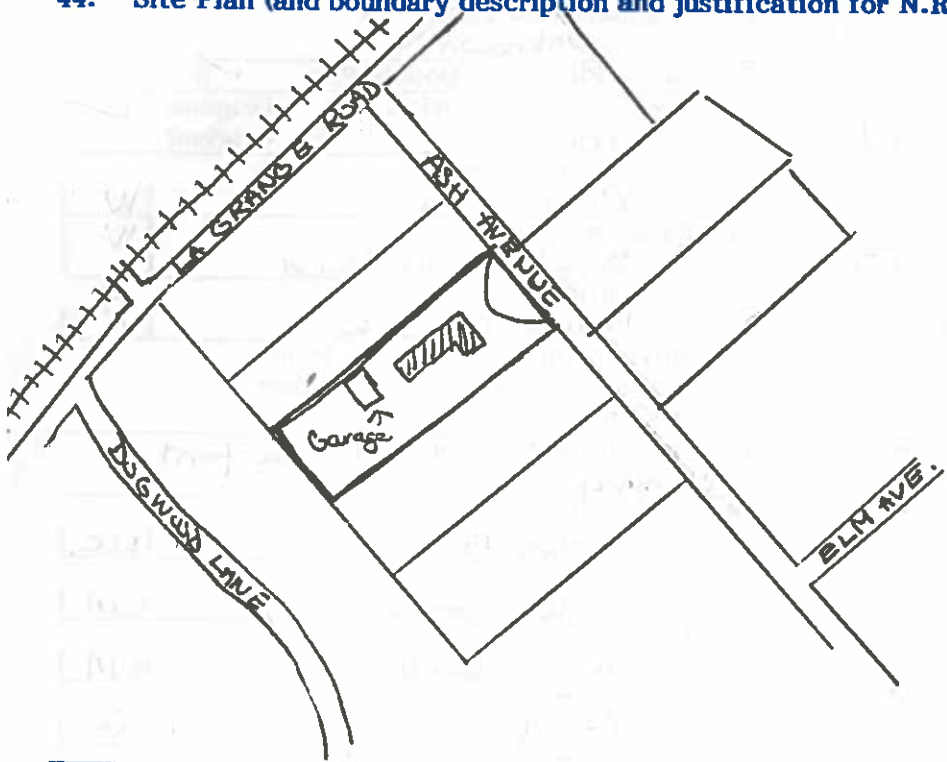

45. Description and House Plan:

A one-and-one-half story T-plan house with gable roof with a projecting central front gable wing. Front facade is detailed with large, rustic exterior brick chimney trimmed with stone. A round-arched front door is set in the chimney brick. Siding is weatherboard; windows are 6-over-1 sash; foundation is poured concrete.

Major alterations include massive two-story rear addition including 3 bay garage and large wraparound front porch with hipped roof and Chinese style railing.

1930s garage has new vertical paneling.

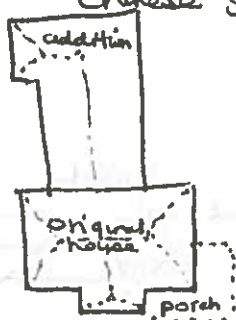

OL-583

275 88

This DEED made and entered into this 20 day of May, 1985, by and between Theresa Joan Vollmer and Richard Vollmer, her husband; Alice M. Cheatham and John Cheatham, her husband; Sister Mary Fulgence (s/p/a Frances Jean Logsdon), single; Sister Joan DePaul (s/p/a Rita Catherine Logsdon), single; Anna Marie State and Frank State, her husband; W. Robert Logsdon and Mary Jean Logsdon, his wife; Clara L. Baker and Charles Baker, her husband; Carl T. Logsdon and Catherine Logsdon, his wife; Edward J. Logsdon and Helen Logsdon, his wife; Lois Logsdon, a widow and unremarried; Paul Logsdon and Annette Logsdon, his wife; Patrick Joseph Logsdon, single; and Beth Ann Logsdon, infant, by and through Lois Logsdon, Guardian, pursuant to Order of Oldham District Court, Case No. 85-P-023, parties of the first part, and Herman E. Clark, Jr. and Karen Sue Clark, his wife, 110 Ash Avenue, Pewee Valley, Kentucky 40056, parties of the second part.

WITNESSETH: That for the total consideration of Seventy-five Thousand Dollars (\$75,000.00), the receipt of which is hereby acknowledged, the parties of the first part hereby convey unto the parties of the second part, jointly for life with the remainder to the survivor of them in fee simple, with Covenant of General Warranty, real estate located in Oldham County, Kentucky, more particularly described as follows:

Beginning at a stone in the center of Ashwood Avenue corner to Jurey, running thence with the center of Ashwood Avenue south 44 1/4 degrees east 205-3/12 feet, thence south 38 3/4 degrees west 561 feet to a point in the line of W. H. Dulaney, thence with the said line of Dulaney North 44 1/4 degrees west 200 feet to a point in a line of Jurey, thence with the

line of Jurey North 38 1/4 degrees east 561 feet to low point of beginning.

being the same property conveyed to William F. Logsdon and Mary C. Logsdon, his wife, by joint survivorship Deed dated December 21, 1934 recorded in Deed Book 54, page 493 in the Oldham County Court Clerk's Office.

William F. Logsdon died April 5, 1952 and by reason of the aforesaid survivorship Deed, fee simple title to the above described real estate vested in Mary C. Logsdon, his surviving spouse.

Mary C. Logsdon died testate a resident of Oldham County, Kentucky, on November 27, 1980 and in accordance with her Last Will and Testament dated August 4, 1980 recorded in Will Book 17, page 153 in the Oldham County Court Clerk's Office, the above described real estate was devised to her children.

Edward Jenkins Logsdon, one of the children of Mary C. Logsdon, died intestate a resident of Oldham County, Kentucky on June 16, 1983. See Affidavit of Decent recorded in Deed Book 215, page 86 in the aforesaid Clerk's Office.

WE HAVE AND TO HOLD the above described real estate, with all and singular the appurtenances thereunto, unto the parties of the second part, jointly for life and the remainder to the survivor of them in fee simple with full power of General Warranty.

The parties of the first part further covenant that they are seized of the estate hereby conveyed; they have full power to convey it; that it is free and clear of all encumbrances, except 1985 State, County and School taxes of Pewee Valley City taxes which are to be prorated between the parties hereto as of the date of deed and all taxes and assessments thereafter which the parties of the second part have agreed to pay.

