

DEMOLISHED, JAN. 1990.

KENTUCKY HISTORIC RESOURCES  
Individual Inventory Form

Resource # OL-353  
Oldham County

1. Name of Resource: Old Post Office

2. Original Owner: H. M. Woodruff ?

3. Other Names: -

4. Prehistoric Site  Building Object  
Historic Site  Structure Other

5. Location: 106 Central Avenue.  
(southwest side near Mt. Mercy Divv.)

6. Owner's Name: St. Aloysius Church [P]

7. Owner's Address: 40 Father Vincent Schweizer  
P.O. Box 40B, Pewee Valley, Ky. 40056

8. Evaluation: [G]

9. Recognition & Date:  
Nat. Landmark \_\_\_\_\_ Local Landmark \_\_\_\_\_  
 Nat. Register Aug. 1989 HABS/HAER \_\_\_\_\_  
Highway Marker \_\_\_\_\_ KY Inventory \_\_\_\_\_  
KY Landmark Certificate \_\_\_\_\_

10. N.R. Status & Date: ND August, 1989

11. N.R. Group:  
District Name: Central Avenue Historic [ ]  
Mult. Resource Area: Distict [ ]  
Thematic Name: [ ]

12. Historical Theme:  
Primary: Suburban Development [300]  
Secondary: [ ]  
Other: [ ]

13. Statement of Significance: Significant as  
the first building in Pewee Valley  
constructed to house the post office.  
[A]

14. History: Probably built about 1890  
to house Pewee Valley's post office.  
which was located here for most of  
the years between 1890 and the 1930s.  
The building was considerably  
renovated sometime before 1940.

15. Source of historical information and/or contact person:  
Smith, Katie. Pewee Valley, Land of the  
Little Colonel, 1974.

16. Date:  
Original Building c. 1890 [ 5 ]  
Addition 1960s? [ 2 ]

17. Style: Victorian Vernacular [4V]

18. Architect/Builder: [ ]

19. No. of Stories: One [ 1.0 ]

20. Original Floor Plan: [ ]

21. Single Pile  Double Pile  N.A.

22. Roof Form & Material: Original   
hipped and gabled Not Original

23. Structural Material: Wood framed - Sawn [W]

24. Exterior Material: Wood-weatherboard [W]

25. Foundation Material: [ ]

26. Major Alterations: None   
Moved/Rebuilt  Other   
Additions

27. Special Features: [ ]

28. Outbuildings: None [ ]

29. Original Function: Post office [04H]

30. Present Use: Vacant [99V]

31. Condition: Poor [P]

32. Endangered: May be torn Yes   
down very soon. No

33. Attach Photos:  
Roll: \_\_\_\_\_ Photo Nos: \_\_\_\_\_ No. of Slides: \_\_\_\_\_  
#1 21

34. Prepared by: Carolyn Brooks

35. Organization: Consultant

36. Date: Sept. 15, 1989

37. New Survey  Resurvey

KENTUCKY HISTORIC RESOURCES  
Individual Inventory Form

Resource # OL-353

38. UTM Point of Primary Building: Zone Easting Northing  
Quadrant: Crestwood. 16 632030 4241110 39. G.I.S. Mod. [ ]  
40. Coordi.Accuracy [ ]

41. UTM Points of Boundary (for N. R. eligible sites only):

A. ----- D. -----  
B. ----- E. -----  
C. ----- F. -----

42. Total Acreage in Present Property:

43. Acreage included in proposed N.R. boundary:

44. Site Plan (and boundary description and justification for N.R. sites):

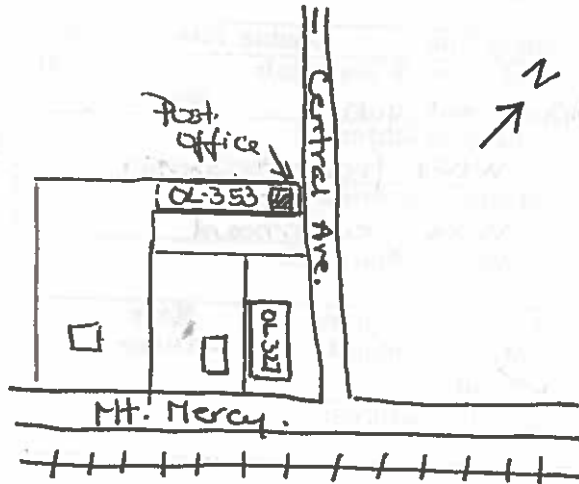

Demolished, Jan. 1990.

45. Description and House Plan:

A T-shaped, one-story building with weatherboard siding. Fronting on Central Ave. is a rectangular hip-roofed section with two front doors and a small central window on its long facade. To the rear is a historic gable-roofed ell that appears in an early photograph. Beyond this is a small shed-roofed non-historic addition. At some point before the 1940s, the entrance was shifted from the southeast end of the front section to the present Central Avenue facade and the roofline was changed from gabled to hipped.

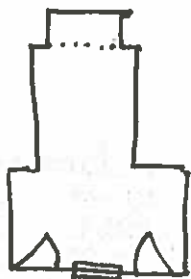

KENTUCKY HISTORIC RESOURCES INVENTORY

Site No. 01 P 353

1. Historic Name(s) <u>Old Post Office</u>		22. ADD/County <u>01</u> <u>093</u>	
2. Present Name <u>Community Bargain Store</u>		23. U.S.G.S. Quadrant (15'/75') <u>Crestwood</u> G.I.S. Mod. <u>    </u>	
3. Location <u>106 Central Ave</u>		24. UTM Reference <u>    </u> <u>    </u> <u>    </u>	
4. Owner's Name <u>    </u>		25. Coordinate Accuracy <u>    </u>	
5. Owner's Address <u>    </u>		26. Prehistoric Site <u>    </u> Object <u>    </u>	
6. Open to Public Yes <u>    </u> No <input checked="" type="checkbox"/>		Historic Site <u>    </u> Structure <u>    </u>	
7. Visible from road Yes <input checked="" type="checkbox"/> No <u>    </u>		Building <input checked="" type="checkbox"/> Other <u>    </u>	
8. Ownership Private <input checked="" type="checkbox"/> Local <u>    </u> State <u>    </u> Federal <u>    </u>		27. National Register District Name <u>    </u>	
9. Local Contact/Organization <u>    </u>		28. Significance Evaluation <u>    </u>	
10. Site Plan with North Arrow		29. Status <u>    </u> Date <u>    </u>	
		National Landmark <u>    </u>	
		National Register <u>    </u>	
11. Architect <u>    </u>		Landmark Certificate <u>    </u>	
12. Builder <u>    </u>		Kentucky Survey <u>    </u>	
13. Date <u>1890</u> A. <input checked="" type="checkbox"/> B. <u>    </u>		Local Landmark <u>    </u>	
14. Style A. <u>Vernacular</u> B. <u>    </u>		HABS/HAER <u>    </u>	
15. Original Use <u>    </u>		30. Historic Theme Primary <u>Politics - Government</u> Secondary <u>    </u> Other <u>    </u>	
16. Present use <u>vacant</u>		31. Endangered Yes <u>    </u> No <input checked="" type="checkbox"/>	
17. Condition <u>fair</u>		32. Preservation Project Status <u>    </u>	
18. Description <u>Small, 1 story T plan w/ wing frame weatherboard. Facade has bell cast hipped roof rear section gabled. 3 bay facade 2 doors, center window Ext brick stove chimney</u>		Actual Cost in \$1,000s <u>    </u>	
No. Stories <u>1</u>		33. ATTACH PHOTO	
Single Pile <u>    </u> Double Pile <u>    </u> Floor Plan <u>T</u>			
Structural Fabric <u>frame</u> A. <input checked="" type="checkbox"/> B. <u>    </u>			
Decorative Fabric <u>weatherboard</u> A. <input checked="" type="checkbox"/> B. <u>    </u>			
Roof Form <u>hipped - gabled</u>		34. Prepared by: <u>Carol's Jobe</u>	
19. History <u>Built by Foley ca 1890 This building served as the PO from 1890 to 1956 The first PO. opened 1856 under the name of Pewee Valley. First postmaster was Chas F. Smith, Henry's son. Several additions were made to the original building.</u>		35. Organization <u>Jeff J</u>	
20. Significance <u>Significant as the first building constructed as a post office, it was in use for more than 60 years.</u>		36. Date <u>8/1</u>	
21. Source of Information <u>Halverson, Pewee Hup its Past Era no date Amelia Moody Norris Summers Katie Smith</u>		37. Revision Dates <u>    </u> 38. Staff Review <u>    </u>	

(Continue on Back)

