

KENTUCKY HISTORIC RESOURCES  
Individual Inventory Form

Resource # 339  
Oldham County

1. Name of Resource: 115 Ash Avenue

2. Original Owner: Unknown

3. Other Names:

4. Prehistoric Site  Building Object  
Historic Site Structure Other

5. Location: 115 Ash Avenue (northeast side of Ash between La Grange Rd. and Elm Ave.)

6. Owner's Name: Kenneth and Ann Hays [P]

7. Owner's Address: 115 Ash Avenue Pewee Valley, Ky. 40056

8. Evaluation: [N]

9. Recognition & Date:  
 Nat. Landmark \_\_\_\_\_ Local Landmark \_\_\_\_\_  
 Nat. Register Aug. 1989 HABS/HAER \_\_\_\_\_  
 Highway Marker \_\_\_\_\_ KY Inventory \_\_\_\_\_  
 KY Landmark Certificate \_\_\_\_\_

10. N.R. Status & Date: ND; August, 1989

11. N.R. Group:  
 District Name: Ashwood Avenue [ ]  
 Mult. Resource Area: Historic District [ ]  
 Thematic Name: [ ]

12. Historical Theme:  
 Primary: Architecture [030]  
 Secondary: Suburban Development [300]  
 Other: [ ]

13. Statement of Significance: A fine example of Colonial Revival style architecture in Pewee Valley. Significant as part of a small building boom in P.V. that accompanied the 1901 completion of the Interurban line to Louisville. [A] [C]

14. History: Located on property that from 1876 until the late 1890s was the home of the Kentucky College for Young Ladies. The present house is believed to have been built c. 1905 some years after the college burned. Numerous land transactions in the early 1900s make the original owner impossible to determine.

15. Source of historical information and/or contact person: Deed Search

16. Date: Original Building c. 1905 [4]  
 Addition [ ]

17. Style: Colonial Revival [51]

18. Architect/Builder: Unknown

19. No. of Stories: Two plus and one [2.5]

20. Original Floor Plan: Asymmetrical [AP]

21. Single Pile Double Pile  N.A.

22. Roof Form & Material: Original   
 Gable Not Original

23. Structural Material: Wood-sawn [W]

24. Exterior Material: Vinyl siding [A]

25. Foundation Material: Limestone block [S]

26. Major Alterations:  None  
 Moved/Rebuilt Other

27. Special Features: Fine front porch with Corinthian columns, dentils and rooftop balustrade.

28. Outbuildings: Cottage - c. 1905; garage - N.C. [ ]

29. Original Function: Single dwelling [OIA]

30. Present Use: Single dwelling [OIA]

31. Condition: Excellent [E]

32. Endangered: Yes  
 No

33. Attach Photos:  
 Roll: Photo Nos: No. of Slides:

2 #5-7, 9, 10  
 5 #17

34. Prepared by: Carolyn Brooks

35. Organization: Consultant

36. Date: Sept. 30, 1989

37. New Survey Resurvey

KENTUCKY HISTORIC RESOURCES  
Individual Inventory Form

Resource # OL

38. UTM Point of Primary Building: Zone Easting Northing 39. G.I.S. Mod. [ ]  
 Quadrant: Crestwood L6 632220 4210770 40. Coordi.Accuracy [ ]

41. UTM Points of Boundary (for N. R. eligible sites only):

A. ----- D. -----  
 B. ----- E. -----  
 C. ----- F. -----

42. Total Acreage in Present Property: 2.5 43. Acreage included in proposed N.R. boundary: 2.5  
 44. Site Plan (and boundary description and justification for N.R. sites):

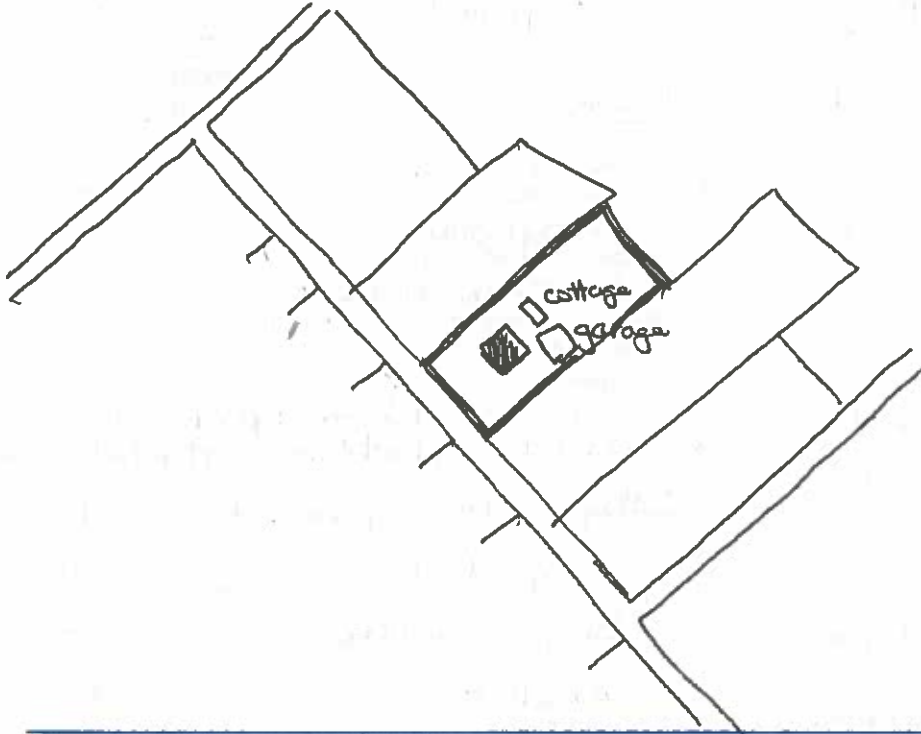

45. Description and House Plan: A rectangular 2 and 1/2 story house with a gable roof. A pedimented front cross gable is balanced by a gable-roofed dormer also on the front. A full width front porch is detailed with truncated Corinthian columns on battered stone plinths, a frieze with a band of dentils, and a neoclassical balustrade. The front door is flanked by side lights <sup>and an overlight</sup>. Windows are 6-over-6 double hung sash. The roof is finished with asphalt shingles of laid in colored bands.

The property is landscaped with large shade trees and evergreens informally scattered around the front. Two sets of historic gate posts are located at the road, limestone block driveway gateposts and <sup>centrally located</sup> fieldstone gateposts that mark a path to the front entrance. To the rear are a, <sup>non-contributing</sup> 1950s concrete block, gable-roofed garage and a c.1905, <sup>contributing</sup> one-room, gable-roofed cottage with vinyl siding.

# KENTUCKY HISTORIC RESOURCES INVENTORY

Site No. 01-P-339

1. Historic Name(s) Mahin or Shelmon House

2. Present Name \_\_\_\_\_

3. Location Ash Ave

4. Owner's Name Walter F. Hayes

5. Owner's Address 115 Ash Ave Pewee Valley 40056

6. Open to Public Yes  No

7. Visible from road Yes  No

8. Ownership  
 Private   
 Local   
 State   
 Federal

9. Local Contact/Organization \_\_\_\_\_

22. ADD/County 01 093

23. U.S.G.S. Quadrant (15'/75') Crestwood G.I.S. Mod.

24. UTM Reference  
 Zone \_\_\_\_\_ Easting \_\_\_\_\_ Northing \_\_\_\_\_

25. Coordinate Accuracy

26. Prehistoric Site \_\_\_\_\_ Object \_\_\_\_\_  
 Historic Site \_\_\_\_\_ Structure \_\_\_\_\_  
 Building  Other \_\_\_\_\_

27. National Register District Name: \_\_\_\_\_

28. Significance Evaluation

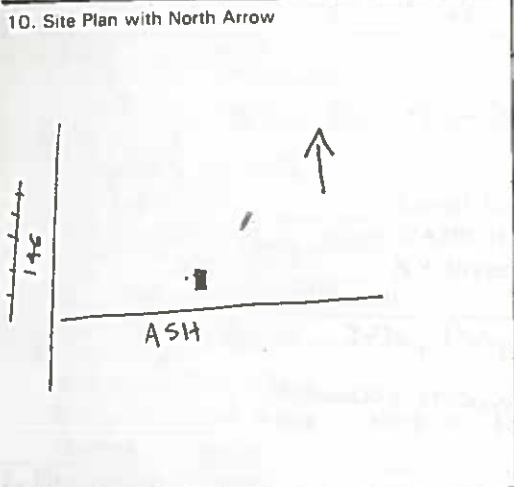

11. Architect \_\_\_\_\_

12. Builder \_\_\_\_\_

13. Date early 1900s A  B

14. Style  
 A   
 B Colo Revival

15. Original Use res

16. Present use res

17. Condition Excellent

No. Stories 2

Single Pile \_\_\_\_\_ NA

Double Pile \_\_\_\_\_

Floor Plan Asymmetrical

Structural Fabric Frame A  B

Decorative Fabric modern siding A  B

Roof Form Gable

29. Status \_\_\_\_\_ Date \_\_\_\_\_  
 National Landmark   
 National Register   
 Landmark Certificate   
 Kentucky Survey   
 Local Landmark   
 HABS/HAER

30. Historic Theme  
 Primary Architecture  3  
 Secondary \_\_\_\_\_  
 Other \_\_\_\_\_

31. Endangered Yes  No

32. Preservation Project Status

Actual Cost in \$1,000s \_\_\_\_\_

18. Description 2 story frame, modern siding. Porch across facade. Short balustrade, Ionic columns on stone square posts. Porch has transom, sidelights. Gable roof dormer. Cornice w/ dentils. Several bay windows. Not brick chimney.



(Continue on Back)

19. History On the site of the Ky College for Young Ladies Built c 1900 after college burned in the late 1890s. Probably built by Shelmon, Mahin lived here many years.

20. Significance Good example of an early 20th century house

Roll No. \_\_\_\_\_

Picture No. \_\_\_\_\_

Direction \_\_\_\_\_

34. Prepared by: Carol Worbe

35. Organization Jeffs

36. Date 8/1

37. Revision Dates \_\_\_\_\_ 38. Staff Review \_\_\_\_\_

21. Source of Information Katie Smith

